

DONJOY looking forward to your visit! Your telecommunications!



东正科技有限公司
DONJOY TECHNOLOGY CO.,LTD.

地址: 温州空港新区港富路25号
总机: 0577-86990888
传真: 0577-86998000

Add: No.25 Gang fu Road, konggang
new District, Longwan Wenzhou, China
Tel: +86-577-86990888
Fax: +86-577-86998000
E-mail: donjoy@cndonjoy.com

www.cndonjoy.com

法律声明:
目录样册版权归东正所有, 如有抄袭, 必将追究其法律责任和经济赔偿。
东正已获得国家版权局书刊号。东正诸多产品技术, 都具有专利保护, 如有抄袭,
必将追究法律责任和经济赔偿。

Legal statement:
Copyright of the catalogue belongs to Donjoy. If there is plagiarism,
it will be investigated for legal responsibility and economic compensation.
Donjoy has been granted publications number by China's National Copyright.
Donjoy products and technology with patent protection,
If there is plagiarism, it will be investigated for legal responsibility
and economic compensation.

Angle seat valve

07 / 角座阀 智能制造



国家高新技术企业 专精特新企业

Advantages

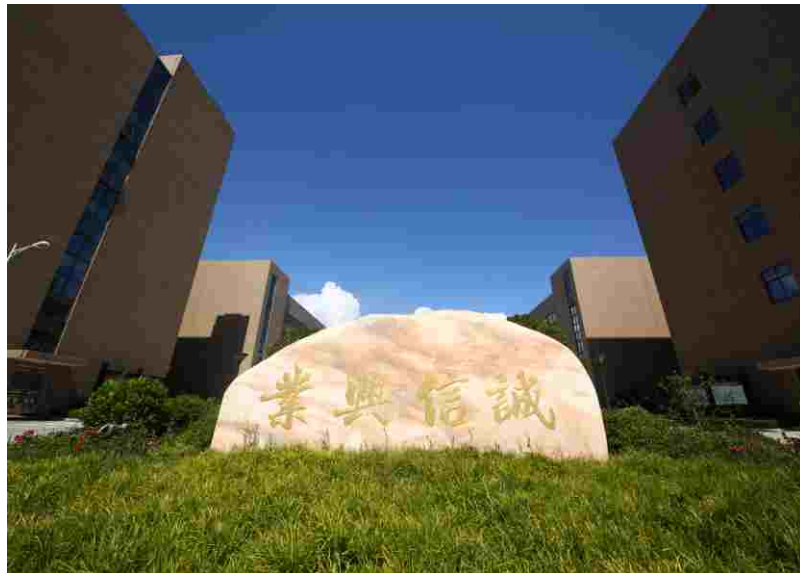

30 YEARS

30年的阀门研发与制造
More than 30 years valve and pump R&d and Manufacturing

23 YEARS

23年的高洁净泵研发与制造
More than 23 years high purity pump R&d and Manufacturing

18 YEARS

18年的阀门控制器研发与制造
More than 18 years valve controller R&d and Manufacturing

15 YEARS

15年的清洗技术研发与制造
More than 15 years Cleaning technology R&d and Manufacturing

300

300多人的专业团队
A profession team of over 300 people

200

200多项知识产权
More than 200 intellectual property rights

30

30多项国际权威认证
More than 30 international authoritative certifications

20

20多项国家与省级荣誉
More than 20 national and provincial honors certificates

超过10年研发经验
工程师队伍
We have more than 10 years experienced engineer team in R & D.

日本Mazak
CNC复合型加工中心
CNC切削中心
CNC车床
Japan Mazak
CNC compound machining center
CNC cutting center
CNC lathe

发那科《Fanuc》
全自动机器人生产线
《Fanuc》 Automatic robot
production line

高新技术企业、
省著名商标、
主任质量奖、4项发明、
200余项专利
New high-tech enterprise.
Provincial famous trademark.
Director's Quality Award.4 inventions
More than 200 patents

欧盟CE
美国3-A, FDA
中国特种制造许可证 TS
防爆认证ATEX CNEX
European Union CE certificate
USA 3-A, FDA
China Special Manufacturing
License TS
ATEX CNEX

我们能为你提供
定制化技术服务和制造,
OEM ODM
We can provide
you OEM & ODM service

领先的检测手段,
30多台专业检测设备和
50多种检测方法, 确保
每个产品性能和精度
Advanced detection method,
More than 30 pcs professional
testing equipment. More than
50 inspection ways, insure product
performance and accuracy

30 YEARS

30年洁净领域的专注
30 years of focus in the field of cleanliness

30 YEARS

30年工程应用经验与市场考验
30 years of engineering application experience and market test

三十而立正蕴含着新的力量，
未来我们将一如既往的致力于技术革新！
We Donjoy have established for 30 years, still full of
new energy, in the future we will stick to concentrate on
technology innovation

Introduction

东正创立于1993年，占地面积29000m²，注册资本1.0558亿元，员工300余人，技术团队30余人，200余项知识产权，国际权威认证30余项，国家与省级荣誉证书20余项，且拥有国际领先的加工技术和制造设备，如Mazak CNC四轴、五轴加工中心、复合型切削中心、FANUC机器人生产线以及各种国际领先的检测设备。

东正制造的产品远销全球并获得国内外用户高度好评，我们产品和技术涵盖高洁净泵、阀门控制技术、PID自控阀门、高洁净阀门、容器管道安全控制技术、容器清洗技术、容器管道照明技术、过滤技术以及高洁净管道和配件等。广泛应用于生物制药、食品饮料、酿酒、精细化工、日化洗涤、纺织印染、电池和新能源等工业领域。

Donjoy is founded in 1993, covers an area of 29,000 square meters, registered capital of 105.58 million yuan, we have more than 300 employees, we have more than 30 persons technical team, we have more than 200 intellectual property rights, we have more than 30 authoritative international certification, we have more than 20 national and provincial certifications, and has an international leader of first processing technology and manufacturing equipment, such as Mazak CNC four axis, five axis machining center, compound cutting center, FANUC robot production line and various international collar first detection equipment, etc.

The products manufactured by Donjoy are sold all over the world and are highly praised by domestic and overseas Products and technology cover high purity pump, valve control technology, PID automatic control valve, high purity valve, container pipeline safety control technology, container cleaning technology, container pipe road lighting technology, filtration technology and high purity pipes and accessories. Widely used in the biopharmaceuticals, food and beverage, wine, fine chemicals, daily chemical washing, textile printing and dyeing, battery and new energy and other industrial fields.



Certification

东正——拥有诸多的产品认证和各种资质其包含国家高新技术、专精特新、省著名商标、知名商号、科技型、创新型、专利示范、研发中心、AAA重合同守信用等各种国家省市级权威荣誉证书。

产品认证:

- 美国卫生认证: 3-A: 涵盖了90%的产品, 其包含各种形式阀门、泵系列等。FDA: 177.2600, 177.1550, 其包含各种橡胶和PTFE及各种密封制品等。
- 欧盟安全认证: CE: 其涵盖了100%各种阀门和泵系列: PED/2014/68/EC, MD06/42/EC。ATEX: 6大系列其包含阀门定位器、阀门控制单元、阀门位置反馈器等。
- 特种制造许可证: 国家安全阀特种制造许可证: TSF33008-2019
- 卫生许可批件: 浙卫水字(2012)第0056号
- 防爆认证: Ex db IIC T6 Gb, Ex tb IIIC T80°C Db



Donjoy has many product certification qualifications, including national high-tech, Specialized and very new, provincial famous trademark, well-known trade name, technology-based, innovative, patent demonstration, R&D center, AAA contract and trustworthy and other national, provincial and municipal authoritative honorary certificates.

- Product certification:
- U.S. Sanitary Certification
 - 3-A: Covers 90% of products, including all kinds of valves, pump, etc.
 - FDA: 177.2600, 177.1550, containing various rubber, PTFE and other sealing products.
 - EU safety certification
 - CE: covers all kinds of valves and pumps: PED/2014/68/EC, MD06/42/EC.
 - ATEX: 6 major series, including valve positioner, valve control unit, valve position feedback device, etc.
 - Special manufacturing license: National safety valve special manufacturing license: TSF33008-2019
 - Sanitation license approval document: Zhewei Shuizi (2012) No. 0056
 - Flameproof certification: Ex db IIC T6 Gb, Ex tb IIIC T80°C Db

角座阀 Angle seat valve

JZ type

角座阀具有与通径相等的通量，极小流阻、启闭无噪音、无死角、可适用于真空环境、设计款型多样。

The angle seat valve has the same flux as the diameter, minimal flow resistance, no noise during opening and closing, no dead angle, It can be used in vacuum environment and has various designs.



产品应用

角座阀是自动控制系统中常用的管路开关，被广泛应用于印织印染、漂白、食品、洗涤、化工、水处理、医药等各种自动机械设备，具有抗水锤、无噪声、密封性能可靠等特点。

Applications

Angle seat valve is a general switch in the automatic control system is widely used in printing, dyeing, bleaching, foodwashing, chemical, water treatment, pharmacy and other automated machinery and equipment. It featured with waterhammer protection, noise-free, reliable sealing performance

技术特点

- 规格: 1/2"-4", DN10-DN100
- 材质: 316L/1.4404, ASME BPE 316L 1.4435 NB2 Fe ≤ 0.5%
- 压力: 真空~10bar(1.0 MPa)
- 温度: -20°C 到 +150°C, 取决密封于材质
- 密封: PTFE/TFM/PEEK
- 连接标准: DIN SMS ISO IDF RJT BS4825 ASME BPE 3A DIN11864 DIN11853
- 连接方式: 螺纹、卡箍、焊接、法兰
- 驱动方式: 手动、气动、电动
- 光洁度: Ra ≤ 0.6 μm; MP=Ra ≤ 0.3 μm; EP=Ra ≤ 0.3 μm
- 认证: FDA 177.2600; Glass II USP Glass VI Chapter 88; GB4806.11; EG VO/1935-2004; PED/97/23/EC;

Technical Features

- Specifications: 1/2"-4", DN10-DN100
- Material: 316L/1.4404, ASME BPE 316L 1.4435 NB2 Fe ≤ 0.5%
- Pressure: vacuum to 10bar (1.0 MPa)
- Temperature: -20°C to +150°C, Depending on the seal material
- Sealing: PTFE/TFM/PEEK
- Connection standard: DIN SMS ISO IDF RJT BS4825 ASME BPE 3A DIN11864 DIN11853
- Connection method: thread, clamp, welding, flange
- Drive mode: manual, pneumatic, electric
- Finish: Ra ≤ 0.6 μm; MP=Ra ≤ 0.3 μm; EP=Ra ≤ 0.3 μm
- Certification: FDA 177.2600; Glass II USP Glass VI Chapter 88; GB4806.11; EG VO/1935-2004; PED/97/23/EC;



不同连接方式 Different Connection Methods

- | | |
|--------|------------------|
| 1、内螺纹 | 1.Female thread |
| 2、焊接 | 2.Welding |
| 3、卡箍 | 3.Clamp |
| 4、螺母 | 4.Nut |
| 5、螺纹 | 5.Male thread |
| 6、无菌法兰 | 6.Aseptic flange |
| 7、法兰 | 7.Flange |

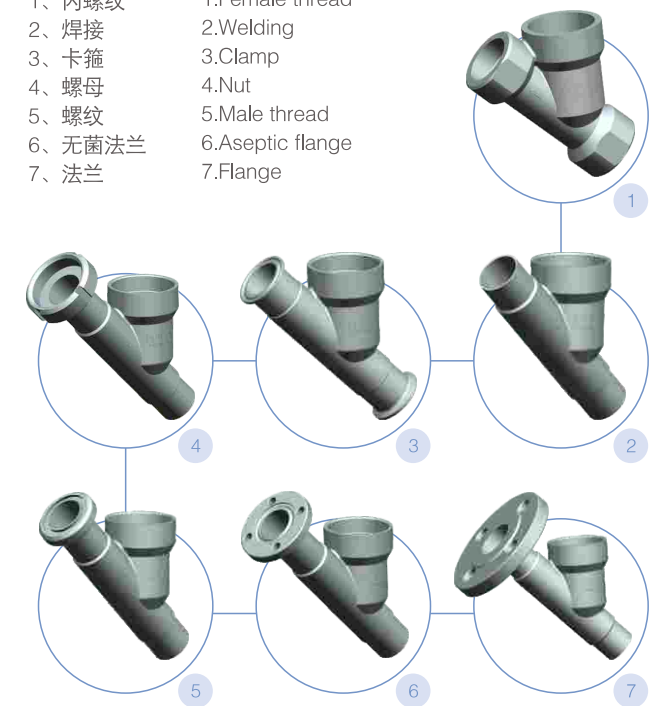

迷你型角座阀系列 Mini angle seat valve series

JZ-Mini type

Size: DN10-DN20, 1/2"-3/4"



JZ-S type

Size: DN25-DN65, 1"-3"

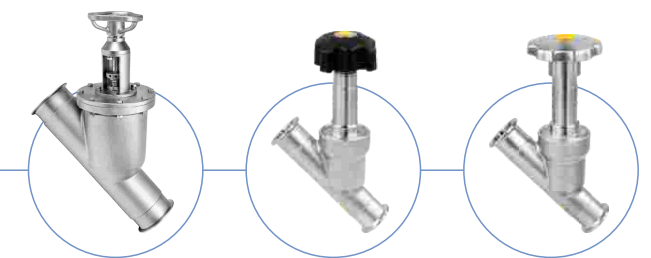

角座阀 Angle seat valve

JZ-F type

Size: 3"-4", DN65-DN100

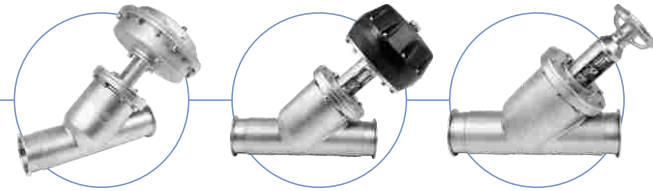

电动角座阀 Electric angle seat valve

JZ-D type

Size: 1/2"-4", DN10-DN100

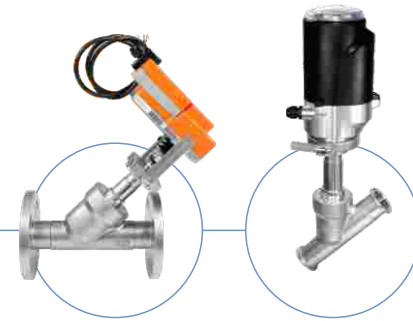

自控角座阀 Self-controlled angle seat valve

JZ-Q type

Size: 1"-2.5", DN25-DN65



手动焊接式角座阀/手动卡箍式角座阀-数据图 (0.5"-4")

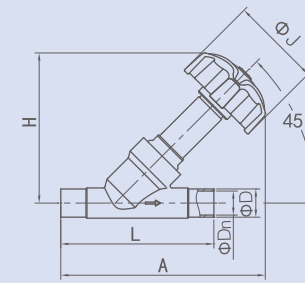

塑料手动角座阀 焊接式阀体 (0.5"-3")
NO.VJZ100S2

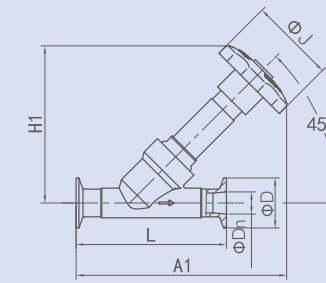

不锈钢手动角座阀 卡箍式阀体 (0.5"-3")
NO.VJZ110S1

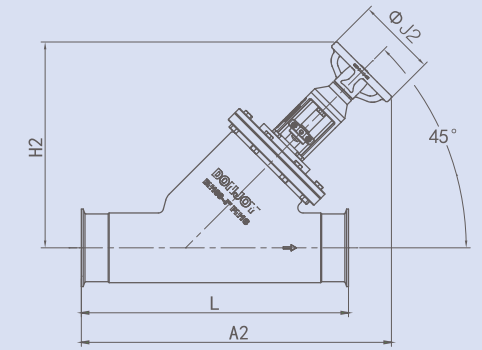

不锈钢手动角座阀 卡箍式阀体 (4")
NO.VJZ110S1

INCH

规格	D	Dn	K	L	A	H	A1	H1	J	A2	H2	J2
0.5"	12.7	9.4	25	130	177	127	187.8	137.8	90	/	/	/
0.75"	19.1	15.8	25	130	177	127	187.8	137.8	90	/	/	/
1"	25.4	22.1	50.5	152	203.4	149.4	214.2	160.2	90	/	/	/
1.25"	31.8	28.5	50.5	180	222.3	158.3	228.1	164.1	90	/	/	/
1.5"	38.1	34.8	50.5	180	220.6	159.6	226.5	165.5	90	/	/	/
2"	50.8	47.5	64	210	244.1	174.1	249.9	179.9	90	/	/	/
2.5"	63.5	59.5	77.5	240	265.5	185.5	271.3	191.3	90	/	/	/
3"	76.2	72.2	91	270	294	206	299.8	211.8	90	/	/	/
4"	101.6	97.6	119	410	/	/	/	/	/	476.9	316.9	121

DIN

规格	D	Dn	K	L	A	H	A1	H1	J	A2	H2	J2
DN10	12	9	34	130	177	127	187.8	137.8	90	/	/	/
DN15	18	15	34	130	177	127	187.8	137.8	90	/	/	/
DN20	22	19	34	130	177	127	187.8	137.8	90	/	/	/
DN25	28	25	50.5	152	203.4	149.4	214.2	160.2	90	/	/	/
DN32	34	31	50.5	180	222.3	158.3	228.1	164.1	90	/	/	/
DN40	40	37	50.5	180	220.6	159.6	226.5	165.5	90	/	/	/
DN50	52	49	64	210	244.1	174.1	249.9	179.9	90	/	/	/
DN65	70	66	91	270	294	206	299.8	211.8	90	/	/	/
DN100	104	100	119	410	/	/	/	/	/	476.9	316.9	121

角座阀 Angle seat valve

气动焊接式角座阀/气动卡箍式角座阀-数据图 (0.5"-4")

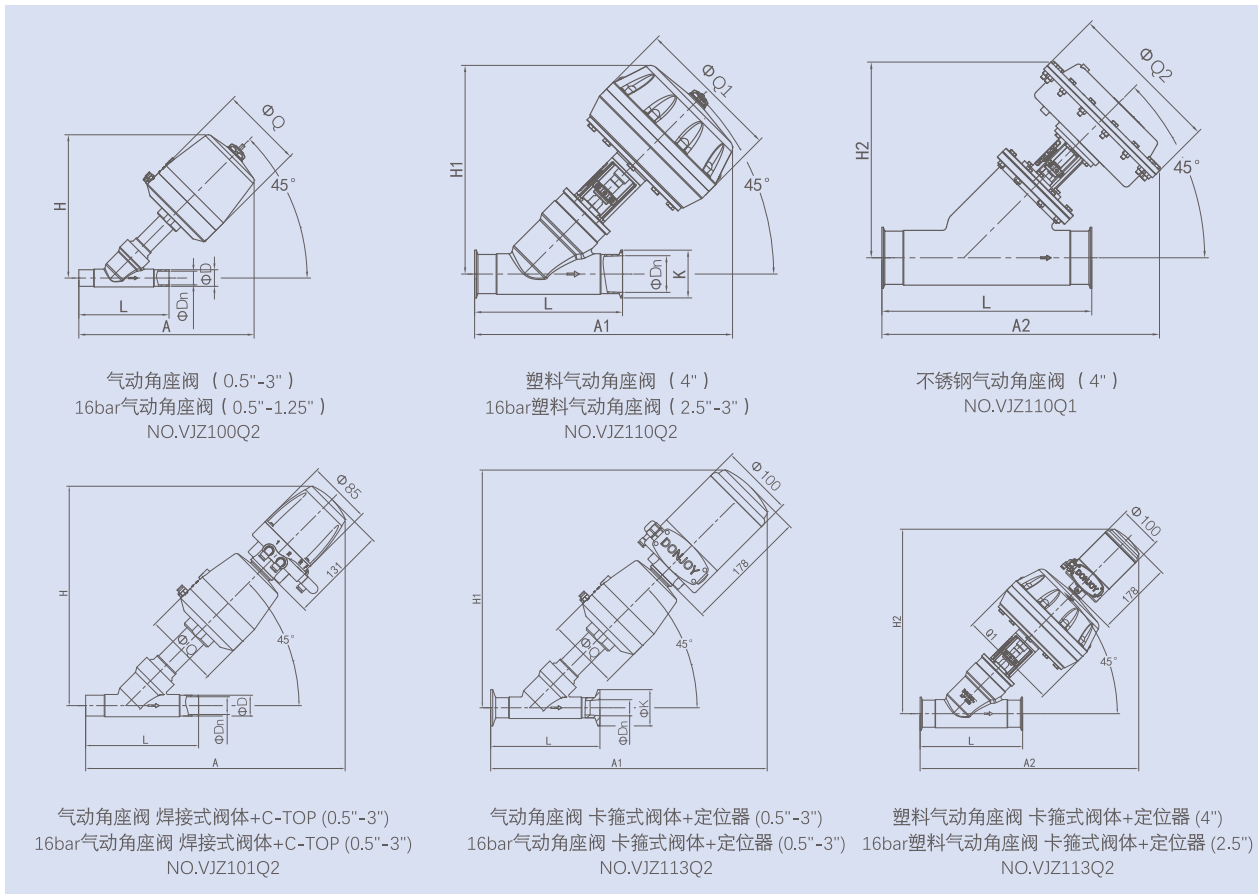

INCH 气动焊接式角座阀/气动卡箍式角座阀-数据图 (0.5"-4")

规格	D	Dn	K	L	A	H	Q	A1	H1	Q1	A2	H2	Q2
0.5"	12.7	9.4	25	130	224.3	174.3	70	/	/	/	/	/	/
0.5" (16bar)	12.7	9.4	25	130	232.8	182.8	100	/	/	/	/	/	/
0.75"	19.1	15.8	25	130	224.3	174.3	70	/	/	/	/	/	/
0.75" (16bar)	19.1	15.8	25	130	232.8	182.8	100	/	/	/	/	/	/
1"	25.4	22.1	50.5	152	258.7	204.7	100	/	/	/	/	/	/
1" (16bar)	25.4	22.1	50.5	152	295.5	241.5	137	/	/	/	/	/	/
1.25"	31.8	28.5	50.5	180	277.5	213.5	100	/	/	/	/	/	/
1.25" (16bar)	31.8	28.5	50.5	180	314.3	250.3	137	/	/	/	/	/	/
1.5" (16bar)	38.1	34.8	50.5	180	315.8	251.8	137	/	/	/	/	/	/
2"	50.8	47.5	64	210	335.9	265.9	137	/	/	/	/	/	/
2.5"	63.5	59.5	77.5	240	357.2	277.2	137	/	/	/	/	/	/
2.5" (16bar)	63.5	59.5	77.5	240	/	/	/	418.5	338.5	235	372.5	292.5	208
3"	76.2	72.2	91	270	376.5	288.5	137	/	/	/	/	/	/
3" (16bar)	76.2	72.2	91	270	/	/	/	433.6	345.6	235	387.6	299.6	208
4"	101.6	97.6	119	410	/	/	/	548	388	235	542.3	382.3	300

DIN 气动焊接式角座阀/气动卡箍式角座阀-数据图 (0.5"-4")

规格	D	Dn	K	L	A	H	Q	A1	H1	Q1	A2	H2	Q2
DN10	12	9	34	130	224.3	174.3	70	/	/	/	/	/	/
DN10 (16bar)	12	9	34	130	232.8	182.8	100	/	/	/	/	/	/
DN15	18	15	34	130	224.3	174.3	70	/	/	/	/	/	/
DN15 (16bar)	18	15	34	130	232.8	182.8	100	/	/	/	/	/	/
DN20	22	19	34	130	224.3	174.3	70	/	/	/	/	/	/
DN20 (16bar)	22	19	34	130	232.8	182.8	100	/	/	/	/	/	/
DN25	28	25	50.5	152	258.7	204.7	100	/	/	/	/	/	/
DN25 (16bar)	28	25	50.5	152	295.5	241.5	137	/	/	/	/	/	/
DN32	34	31	50.5	180	277.5	213.5	100	/	/	/	/	/	/
DN32 (16bar)	34	31	50.5	180	314.3	250.3	137	/	/	/	/	/	/
DN40 (16bar)	40	37	50.5	180	315.8	251.8	137	/	/	/	/	/	/
DN50	52	49	64	210	335.9	265.9	137	/	/	/	/	/	/
DN65	70	66	91	270	376.5	288.5	137	/	/	/	/	/	/
DN65 (16bar)	70	66	91	270	/	/	/	433.6	345.6	235	387.6	299.6	208
DN100	104	100	119	410	/	/	/	548	388	235	542.3	382.3	300

INCH 气动焊接式角座阀/气动卡箍式角座阀+C-TOP/定位器-数据图 (0.5"-4")

规格	D	Dn	K	L	A	H	A1	H1	Q	A2	H2	Q1
0.5"	12.7	9.4	25	130	322.6	272.6	361.6	311.6	70	/	/	/
0.5" (16bar)	12.7	9.4	25	130	323.3	273.3	362.3	312.3	100	/	/	/
0.75"	19.1	15.8	25	130	322.6	272.6	361.6	311.6	70	/	/	/
0.75" (16bar)	19.1	15.8	25	130	323.3	273.3	362.3	312.3	100	/	/	/
1"	25.4	22.1	50.5	152	349.3	295.3	388.2	334.2	100	/	/	/
1" (16bar)	25.4	22.1	50.5	152	377.9	323.9	416.9	362.9	137	/	/	/
1.25"	31.8	28.5	50.5	180	368.1	304.1	407.1	343.1	100	/	/	/
1.25" (16bar)	31.8	28.5	50.5	180	396.7	332.7	435.7	371.7	137	/	/	/
1.5" (16bar)	38.1	34.8	50.5	180	398.2	334.2	434.1	373.1	137	/	/	/
2"	50.8	47.5	64	210	418.3	348.3	457.3	387.3	137	/	/	/
2.5"	63.5	59.5	77.5	240	439.6	359.6	478.6	398.6	137	/	/	/
2.5" (16bar)	63.5	59.5	77.5	240	/	/	/	/	/	515.4	435.4	235
3"	76.2	72.2	91	270	458.9	370.9	497.9	409.9	137	/	/	/
3" (16bar)	76.2	72.2	91	270	/	/	/	/	/	530.4	442.4	235
4"	101.6	97.6	119	410	/	/	/	/	/	644.9	484.9	235

DIN 气动焊接式角座阀/气动卡箍式角座阀+C-TOP/定位器-数据图 (0.5"-4")

规格	D	Dn	K	L	A	H	A1	H1	Q	A2	H2	Q1
DN10	12	9	34	130	322.6	272.6	361.6	311.6	70	/	/	/
DN10 (16bar)	12	9	34	130	323.3	273.3	362.3	312.3	100	/	/	/
DN15	18	15	34	130	322.6	272.6	361.6	311.6	70	/	/	/
DN15 (16bar)	18	15	34	130	323.3	273.3	362.3	312.3	100	/	/	/
DN20	22	19	34	130	322.6	272.6	361.6	311.6	70	/	/	/
DN20 (16bar)	22	19	34	130	323.3	273.3	362.3	312.3	100	/	/	/
DN25	28	25	50.5	152	349.3	295.3	388.2	334.2	100	/	/	/
DN25 (16bar)	28	25	50.5	152	377.9	323.9	416.9	362.9	137	/	/	/
DN32	34	31	50.5	180	368.1	304.1	407.1	343.1	100	/	/	/
DN32 (16bar)	34	31	50.5	180	396.7	332.7	435.7	371.7	137	/	/	/
DN40 (16bar)	40	37	50.5	180	418.3	348.3	457.3	387.3	137	/	/	/
DN50	52	49	64	210	439.6	359.6	478.6	398.6	137	/	/	/
DN65	70	66	91	270	458.9	370.9	497.9	409.9	137	/	/	/
DN65 (16bar)	70	66	91	270	/	/	/	/	/	530.4	442.4	235
DN100	104	100	119	410	/	/	/	/	/	644.9	484.9	235

角座阀 Angle seat valve

手动螺纹式角座阀-数据图 (0.5"-2.5")

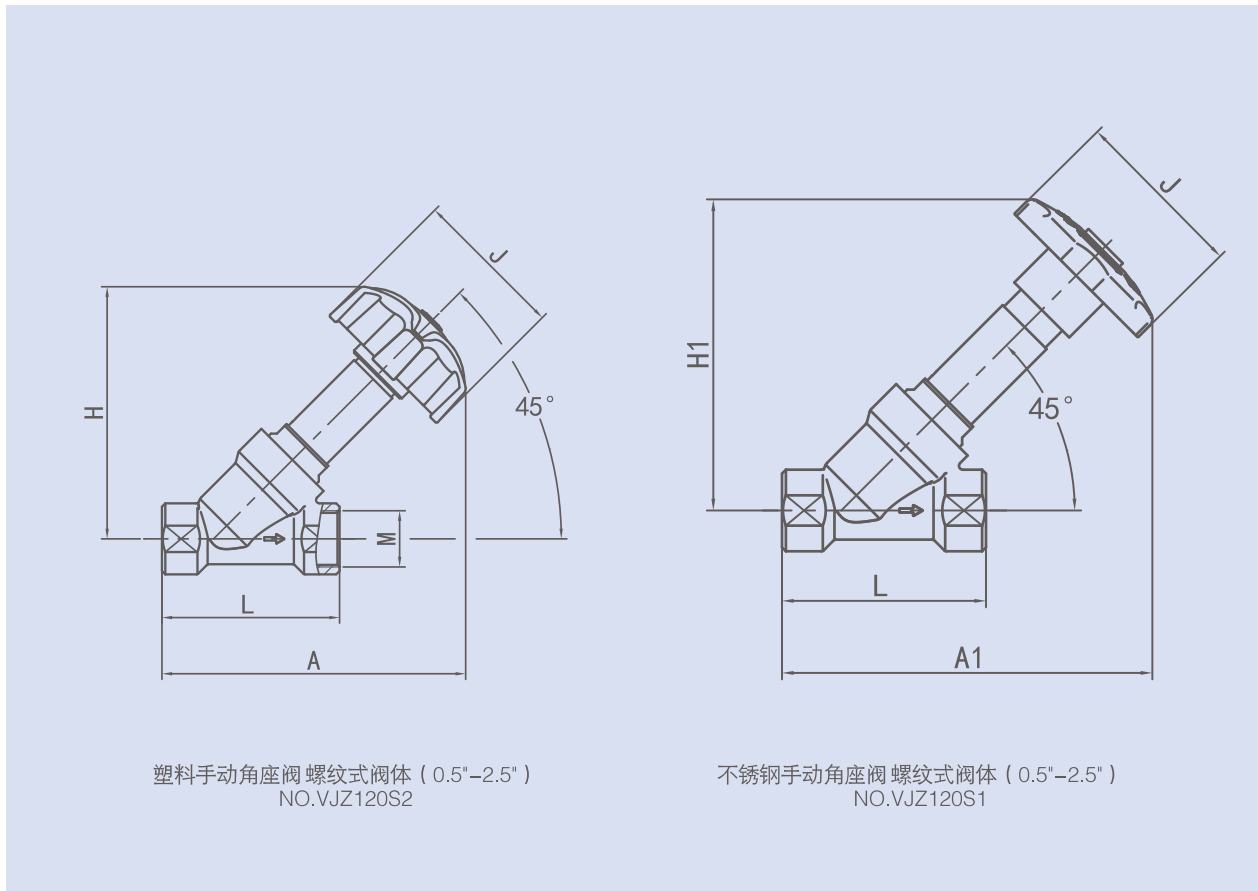

气动螺纹式角座阀-数据图 (0.5"-2.5")

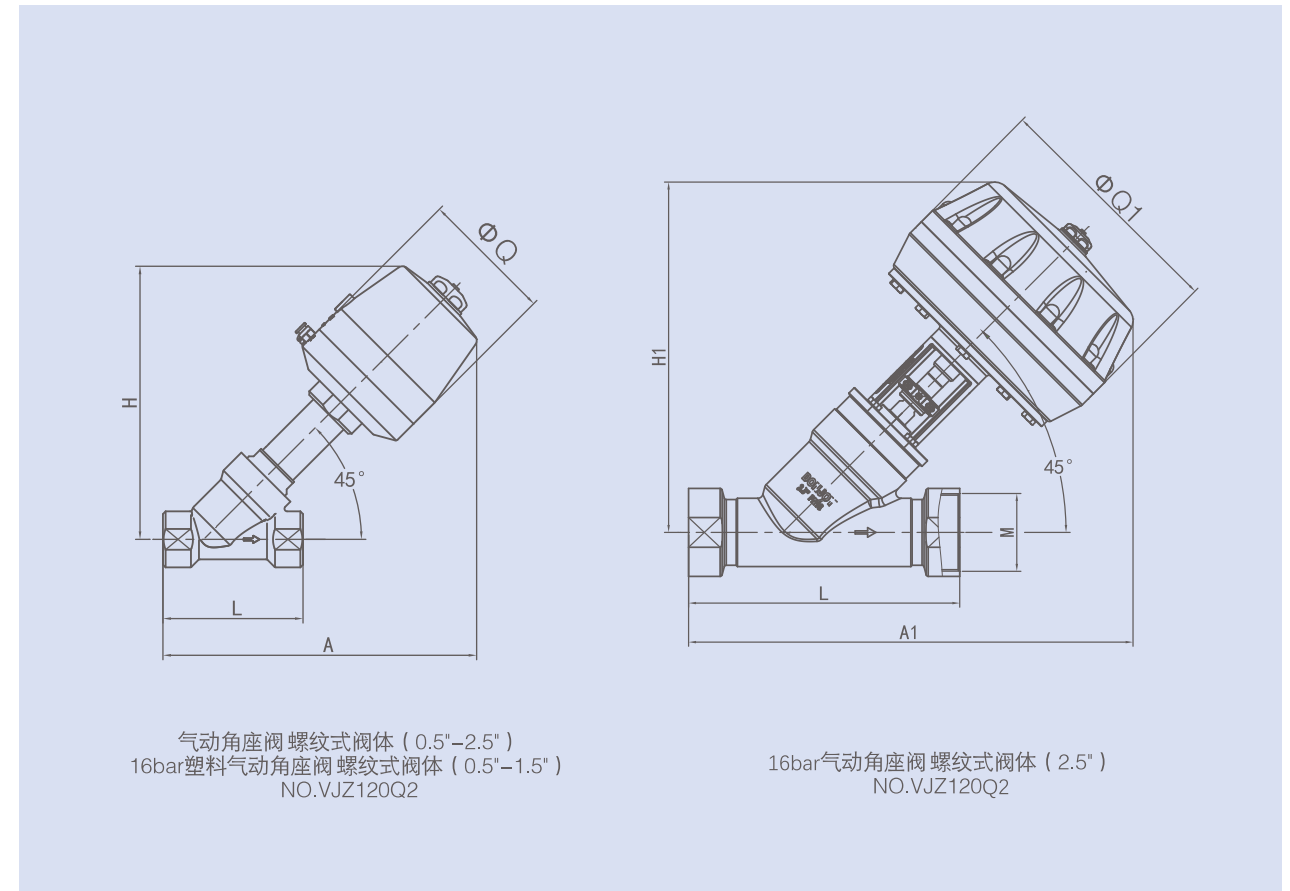

INCH							
规格	M BSP/BSPT/NPT	L	A	H	A1	H1	J
0.5"	0.5"	95	162	127	172.8	137.8	90
0.75"	0.75"	95	162	127	172.8	137.8	90
1"	1"	105	179.9	149.4	190.7	160.2	90
1.5"	1.5"	140	204.6	159.6	210.5	165.5	90
2"	2"	170	224.1	174.1	229.9	179.9	90
2.5"	2.5"	262	276.5	185.5	282.3	191.3	90

INCH								
规格	M BSP/BSPT/NPT	L	A	H	Q	A1	H1	Q1
0.5"	0.5"	95	209.3	174.3	70	/	/	/
0.5" (16bar)	0.5"	95	217.8	182.8	100	/	/	/
0.75"	0.75"	95	209.3	174.3	70	/	/	/
0.75" (16bar)	0.75"	95	217.8	182.8	100	/	/	/
1"	1	105	235.2	204.7	100	/	/	/
1" (16bar)	1"	105	272	241.5	137	/	/	/
1.5" (16bar)	1.5"	140	296.8	251.8	137	/	/	/
2"	2"	170	315.9	265.9	137	/	/	/
2.5"	2.5"	262	368.2	272.2	137	/	/	/
2.5" (16bar)	2.5"	262	/	/	/	429.5	338.5	235



注意：以上数据图相关尺寸不作为实物最终依据，东正保留对于数据更新权限不再另行通知。
Note: The relevant dimensions of the above data diagrams are not regarded as the final basis of the actual object. Dongzheng reserves the right to update the data without further notice.

注意：以上数据图相关尺寸不作为实物最终依据，东正保留对于数据更新权限不再另行通知。
Note: The relevant dimensions of the above data diagrams are not regarded as the final basis of the actual object. Dongzheng reserves the right to update the data without further notice.

角座阀 Angle seat valve

手动螺纹式角座阀-数据图 (0.5"-2.5")

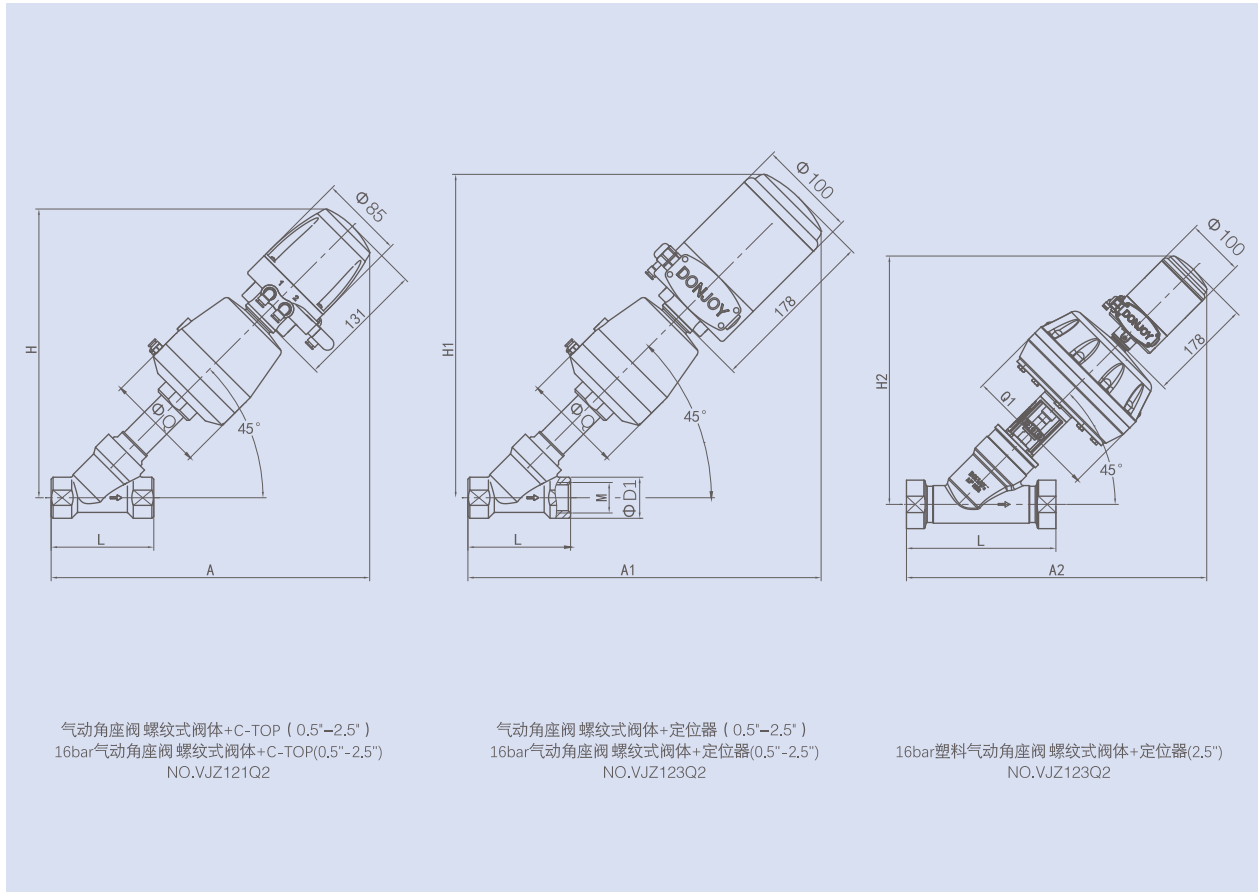

INCH										
规格	M BSP/BSPT/NPT	L	A	H	A1	H1	Q	A2	H2	Q1
0.5"	0.5"	95	307.6	272.6	346.6	311.6	70	/	/	/
0.5" (16bar)	0.5"	95	308.3	273.3	347.3	312.3	100	/	/	/
0.75"	0.75"	95	307.6	272.6	346.6	311.6	70	/	/	/
0.75" (16bar)	0.75"	95	308.3	273.3	347.3	312.3	100	/	/	/
1"	1"	105	325.8	295.3	364.8	334.2	100	/	/	/
1" (16bar)	1"	105	354.4	323.9	393.4	362.9	137	/	/	/
1.5" (16bar)	1.5"	140	379.2	334.2	418.1	373.1	137	/	/	/
2"	2"	170	398.3	348.3	437.3	387.3	137	/	/	/
2.5"	2.5"	262	450.6	359.6	489.6	398.6	137	/	/	/
2.5" (16bar)	2.5"	262	/	/	/	/	/	526.4	435.4	235

注意：以上数据图相关尺寸不作为实物最终依据，东正保留对于数据更新权限不再另行通知。
Note: The relevant dimensions of the above data diagrams are not regarded as the final basis of the actual object. Dongzheng reserves the right to update the data without further notice.

手动法兰式角座阀-数据图 (0.5"-4")

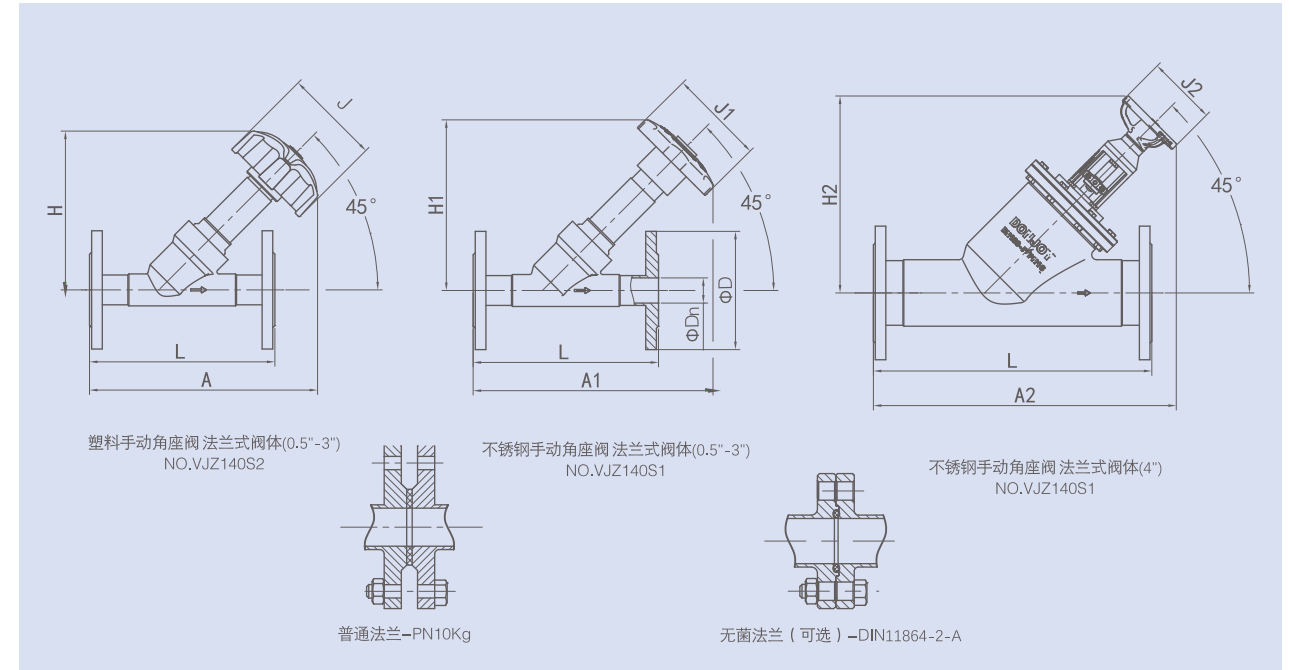

INCH												
规格	D	Dn	L	A	H	J	A1	H1	J1	A2	H2	J2
0.5"	90	9.4	152	188	127	90	198.8	137.8	90	/	/	/
0.75"	95	15.7	152	188	127	90	198.8	137.8	90	/	/	/
1"	115	22.1	178	214.4	149.4	90	225.2	160.2	90	/	/	/
1.25"	135	28.5	210	237.3	158.3	90	243.1	164.1	90	/	/	/
1.5"	145	34.8	214	239	161	90	244.9	166.9	90	/	/	/
2"	160	47.5	244	261.1	174.1	90	266.9	179.9	90	/	/	/
2.5"	180	59.5	274	282.5	185.5	90	288.3	191.3	90	/	/	/
3"	180	72.2	304	311	206	90	316.8	211.8	90	/	/	/
4"	215	97.6	448	/	/	/	/	/	/	495.9	316.9	121

DIN												
规格	D	Dn	L	A	H	J	A1	H1	J1	A2	H2	J2
DN10	90	9	152	188	127	90	198.8	137.8	90	/	/	/
DN15	95	15	152	188	127	90	198.8	137.8	90	/	/	/
DN20	115	19	156	190	127	90	200.8	137.8	90	/	/	/
DN25	135	25	178	214.4	149.4	90	225.2	160.2	90	/	/	/
DN32	145	31	210	237.3	158.3	90	243.1	164.1	90	/	/	/
DN40	160	37	214	239	161	90	244.9	166.9	90	/	/	/
DN50	180	49	244	261.1	174.1	90	266.9	179.9	90	/	/	/
DN65	180	66	304	311	206	90	316.8	211.8	90	/	/	/
DN100	215	100	448	/	/	/	/	/	/	495.9	316.9	124

角座阀 Angle seat valve

气动法兰式角座阀-数据图 (0.5"-4")

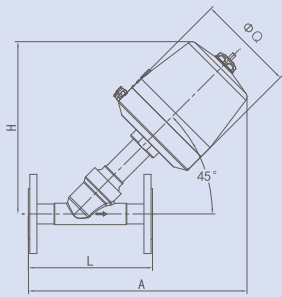

气动角座阀-法兰式阀体 (0.5"-3")
16bar塑料气动角座阀 法兰式阀体 (0.5"-1.25")
NO.VJZ140Q2

气动法兰式角座阀+C-TIP/定位器-数据图 (0.5"-2.5")

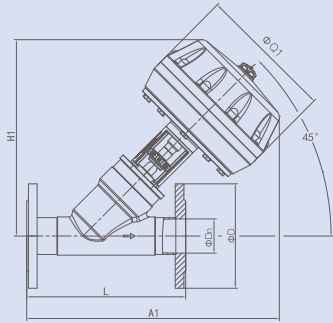

塑料气动角座阀-法兰式阀体 (4")
16bar塑料气动角座阀 法兰式阀体 (2.5"-3")
NO.VJZ140Q1

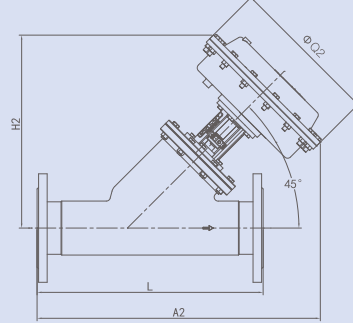

不锈钢气动角座阀-法兰式阀体 (4")
NO.VJZ140Q1

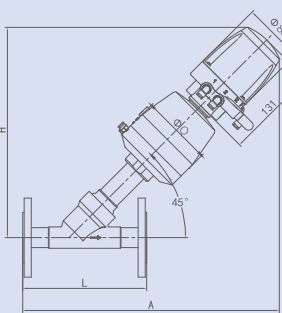

气动角座阀-法兰式阀体+C-TOP (0.5"-3")
16bar塑料气动角座阀 法兰式阀体+C-TOP (0.5"-3")
NO.VJZ141Q2

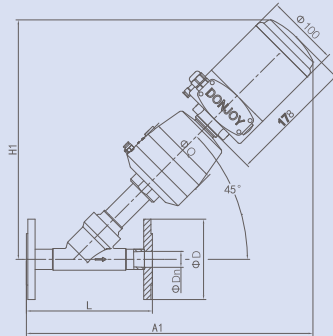

气动角座阀-法兰式阀体+定位器 (0.5"-3")
16bar气动角座阀 法兰式阀体+定位器 (0.5"-3")
NO.VJZ143Q2

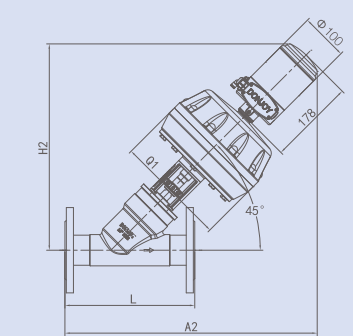

塑料气动角座阀-法兰式阀体+定位器 (4")
16bar塑料气动角座阀 法兰式阀体+定位器 (2.5"-3")
NO.VJZ143Q2

INCH 气动法兰式角座阀-数据图 (0.5"-4")

规格	D	Dn	L	A	H	Q	A1	H1	Q1	A2	H2	Q2
0.5"	90	9.4	152	235.3	174.3	70	/	/	/	/	/	/
0.5" (16bar)	90	9.4	152	243.8	182.8	100	/	/	/	/	/	/
0.75"	95	15.7	152	235.8	174.3	70	/	/	/	/	/	/
0.75" (16bar)	95	15.7	152	243.8	182.8	100	/	/	/	/	/	/
1"	115	22.1	178	269.7	204.7	100	/	/	/	/	/	/
1" (16bar)	115	22.1	178	306.5	241.5	137	/	/	/	/	/	/
1.25"	135	28.5	210	292.5	213.5	100	/	/	/	/	/	/
1.25" (16bar)	135	28.5	210	329.3	250.3	137	/	/	/	/	/	/
1.5" (16bar)	145	34.8	214	331.2	253.2	137	/	/	/	/	/	/
2"	160	47.5	244	352.9	265.9	137	/	/	/	/	/	/
2.5"	180	59.5	274	374.2	277.2	137	/	/	/	/	/	/
2.5" (16bar)	180	59.5	274	/	/	/	435.5	338.5	235	/	/	/
3"	180	72.2	304	393.5	288.5	137	/	/	/	/	/	/
3" (16bar)	180	72.2	304	/	/	/	450.6	345.6	235	404.6	299.6	208
4"	215	97.6	448	/	/	/	567	388	235	561.3	382.3	300

DIN 气动法兰式角座阀-数据图 (0.5"-4")

规格	D	Dn	L	A	H	Q	A1	H1	Q1	A2	H2	Q2
DN10	90	1	152	235.3	174.3	70	/	/	/	/	/	/
DN10 (16bar)	90	1	152	243.8	182.8	100	/	/	/	/	/	/
DN15	95	1	152	235.8	174.3	70	/	/	/	/	/	/
DN15 (16bar)	95	1	152	243.8	182.8	100	/	/	/	/	/	/
DN20	105	19	156	237.3	174.3	70	/	/	/	/	/	/
DN20 (16bar)	105	19	156	245.8	182.8	100	/	/	/	/	/	/
DN25	115	1	178	269.7	204.7	100	/	/	/	/	/	/
DN25 (16bar)	115	1	178	306.5	241.5	137	/	/	/	/	/	/
DN32	135	1	210	292.5	213.5	100	/	/	/	/	/	/
DN32 (16bar)	135	1	210	329.3	250.3	137	/	/	/	/	/	/
DN40 (16bar)	145	34.8	214	330.8	251.8	137	/	/	/	/	/	/
DN50	160	47.5	244	352.9	265.9	137	/	/	/	/	/	/
DN65	180	72.2	304	393.5	288.5	137	/	/	/	/	/	/
DN65 (16bar)	180	72.2	304	/	/	/	450.6	345.6	235	404.6	299.6	208
DN100	215	97.6	448	/	/	/	495.9	316.9	124	561.3	382.3	300

INCH 气动法兰式角座阀+C-TIP/定位器-数据图 (0.5"-2.5")

规格	D	Dn	L	A	H	A1	H1	Q	A2	H2	Q1
0.5"	90	9.4	152	333.6	272.6	372.6	311.6	70	/	/	/
0.5" (16bar)	90	9.4	152	334.3	273.3	373.3	312.3	100	/	/	/
0.75"	95	15.7	152	333.6	272.6	372.6	311.6	70	/	/	/
0.75" (16bar)	95	15.7	152	334.3	273.3	373.3	312.3	100	/	/	/
1"	115	22.1	178	360.3	295.3	399.2	334.2	100	/	/	/
1" (16bar)	115	22.1	178	388.9	323.9	427.9	362.9	137	/	/	/
1.25"	135	28.5	210	383.1	304.1	422.1	343.1	100	/	/	/
1.25" (16bar)	135	28.5	210	411.7	332.7	450.7	371.7	137	/	/	/
1.5" (16bar)	145	34.8	214	413.6	335.6	452.6	374.6	137	/	/	/
2"	160	47.5	244	435.3	348.3	474.3	387.3	137	/	/	/
2.5"	180	59.5	274	456.6	359.6	495.6	398.6	137	/	/	/
2.5" (16bar)	180	59.5	274	/	/	/	/	/	532.4	435.4	235
3"	180	72.2	304	475.9	370.9	514.9	409.9	137	/	/	/
3" (16bar)	180	72.2	304	/	/	/	/	/	547.4	442.4	235
4"	215	97.6	448	/	/	/	/	/	663.9	484.9	235

DIN 气动法兰式角座阀+C-TIP/定位器-数据图 (0.5"-2.5")

规格	D	Dn	L	A	H	A1	H1	Q	A2	H2	Q1
DN10	90	9	152	333.6	272.6	372.6	311.6	70	/	/	/
DN10 (16bar)	90	9	152	334.3	273.3	373.3	312.3	100	/	/	/
DN15	95	15	152	333.6	272.6	372.6	311.6	70	/	/	/
DN15 (16bar)	95	15	152	334.3	273.3	373.3	312.3	100	/	/	/
DN20	105	19	156	335.6	272.6	374.6	311.6	70	/	/	/
DN20 (16bar)	105	19	156	336.3	273.3	375.3	312.3	100	/	/	/
DN25	115	25	178	360.3	295.3	399.2	334.2	100	/	/	/
DN25 (16bar)	115	25	178	388.9	323.9	427.9	362.9	137	/	/	/
DN32	135	31	210	383.1	304.1	422.1	343.1	100	/	/	/
DN32 (16bar)	135	31	210	411.7	332.7	450.7	371.7	137	/	/	/
DN40 (16bar)	145	34.8	214	413.6	335.6	452.6	374.6	137	/	/	/
DN50	160	47.5	244	435.3	348.3	474.3	387.3	137	/	/	/
DN65	180	72.2	304	475.9	370.9	514.9	409.9	137	/	/	/
DN65 (16bar)	180	72.2	304	/	/	/	/	/	547.4	442.4	235
DN100	215	97.6	448	/	/	/	/	/	561.3	382.3	235

比例调节角座阀 Proportional angle seat valve

角座阀曲线特性分为两种设计：1)标准型；2)调节型
Angle seat valve curve characteristics are divided into two designs:
1) standard type; 2) adjustable type



标准型阀门定位器-界面
IL-TOP-1831&1441

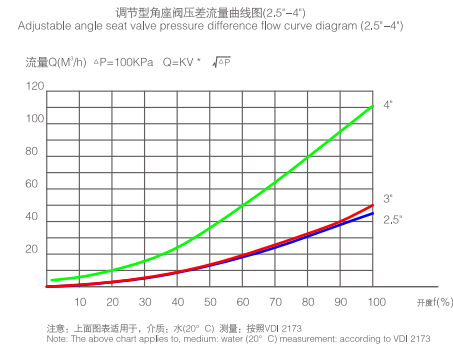
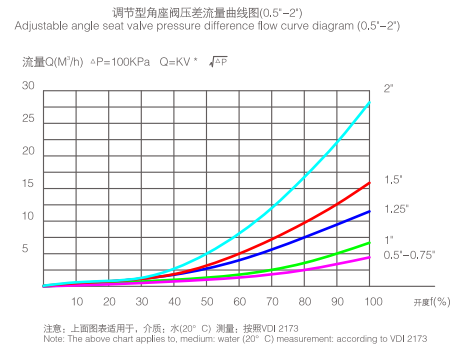
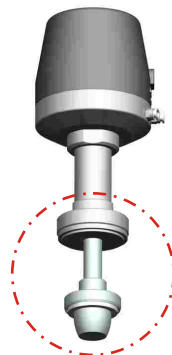
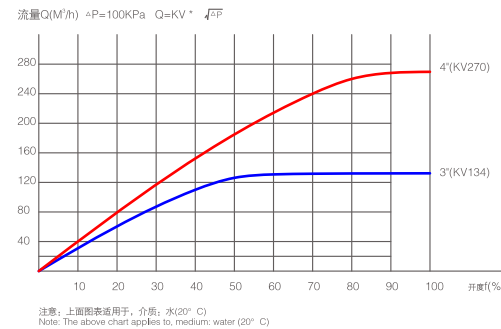
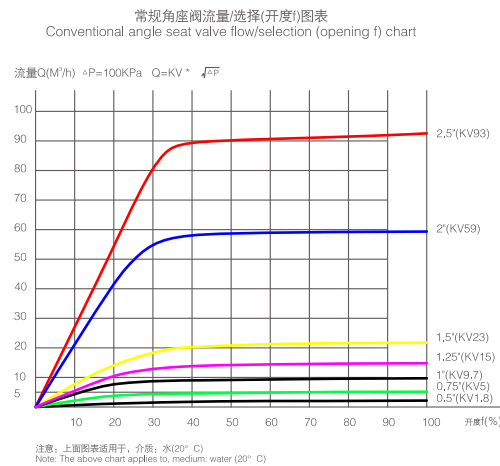
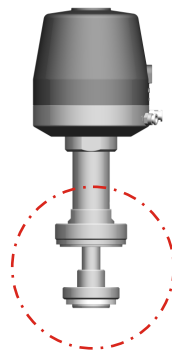

角座阀-截止阀货号编制规则



① 阀门类型代码

VJZ: 角座阀-常规
VJZ-T: 角座阀-调节型

② 两端进出口连接方式

0-焊接式；1-卡箍式；2-内螺纹式；3-外螺纹式；
4-法兰式；5-由任螺母式

③ 表示执行机构

手动系列：S1-塑料手动；S2-不锈钢手动-B型（实心型手轮）
执行器类别：Q1-不锈钢气动执行器；Q2-塑料气动执行器
D1-电动执行器；L1铝合金气动执行器

④ 表示切断气源时阀门状态

C-常闭；O-常开；D-气/气双作用（仅适用于气动）
N-不区分常开常闭（仅用于手动、电动）

⑤ 表示阀门规格

INCH系列（不分标准）	DIN系列	ISO系列	3A系列	SMS系列	RJT系列
OD 1/2"	DN15	ISO1/2"	3A 1/2"	SMS25	RJT1/2"
OD 3/4"	DN20	ISO3/4"	3A 3/4"	SMS32	RJT3/4"
OD 1"	DN25	ISO1"	3A 1"	SMS38	RJT1"
OD 1 1/4"	DN32	ISO1 1/4"		SMS51	RJT1 1/4"
OD 1 1/2"	DN40	ISO1 1/2"	3A 1 1/2"	SMS63	RJT1 1/2"
OD 2"	DN50	ISO2"	3A 2"	SMS76	RJT2"
OD 2 1/2"	DN65	ISO2 1/2"	3A 2 1/2"	SMS89	RJT2 1/2"
OD 3"	DN80	ISO3"	3A 3"	SMS102	RJT3"
OD 3 1/2"	DN100	ISO3 1/2"			RJT3 1/2"
OD 4"	DN125	ISO4"	3A 4"		RJT4"

⑥ 表示阀体材质（与介质接触部分）

6-AISI 316L;

⑦ 表示密封材质（与介质接触部分）

P-PTFE

⑧ 表示附件信息

0-不带附件（此位可省略）；C1-带1只传感器（适用于Q1、Q2、L1执行器）；C2-带2只传感器（适用于Q1、Q2、L1执行器）
C-TOP 1721-带控制器CTOP（适用于Q1、Q2、L1执行器）；IL-TOP 1831-带定位器IL-TOP（适用于Q1、Q2、L1执行器）
F-TOP 1553-带反馈器（适用于Q1、Q2、L1执行器）